

# ABPI PANEL PRODUCTS

FOR INDUSTRIAL, AGRICULTURAL, & COMMERCIAL APPLICATIONS

## ABPI - SQUARE EDGE - DOUBLE SKIN

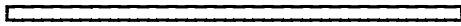
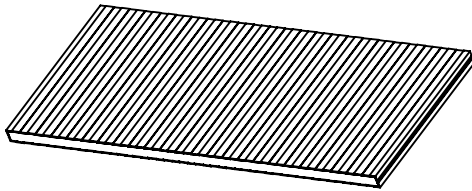

47 1/2"

## TECHNICAL INFORMATION

### Square Edge Panel

Panel Thickness: 1 1/2"

Panel Width: Square Edge 47 1/2" coverage

### Lap Joint / Sleeve Joint Panel

Panel Thickness: 1 1/2", 2", 2 1/2", 3", 4" & 6"

Panel Width: Lap / Sleeve Joint - 33" coverage

Panel Length: Minimum: 4'-0"

Maximum: 40'-0"

other lengths available on request\*\*

## ABPI - LAP JOINT - DOUBLE SKIN (UTILIDOR)

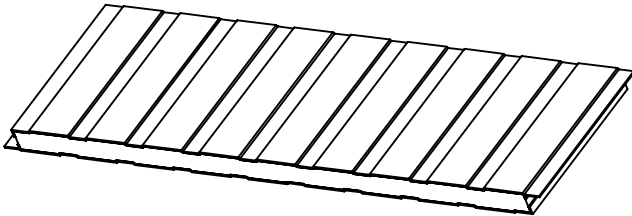

33"

Skin Thickness: Standard 26 ga.

other gauges available by request\*\*

Skin Materials:

Galvanized (G90)

Galvalume

Painted

Stainless Steel by request\*\*

Insulation:

Polyurethane

Density:

2.5 lbs./cu.ft. minimum

R-Value:

R 7.14 / inch

Fire Testing in accordance with CAN/ULC S102-M88

Flame Spread: 65

Smoke Development: 210

C.F.I.A. APPROVAL (on selected panels- # A399)

## WEIGHT CHART: lbs/sq.ft.

Double Skin Skin Material	Panel Thickness						
	Ga.	1.5"	2"	2.5"	3"	4"	6"
Galvanized	26	2.2	2.3	2.4	2.5	2.7	3.1
Galvalume	26	2.1	2.2	2.3	2.4	2.6	3.0
Painted	26	2.1	2.2	2.3	2.4	2.6	3.0
Stainless Steel	26	1.9	2.0	2.1	2.2	2.4	2.8

Please contact ABPI's Technical Department for more info.



A Better Panel Inc.  
Box 6165  
4006 - 60th Ave  
Innisfail, AB  
T4G 1S8  
www.abetterpanel.com  
ph: 403-227-4545  
fax: 403-227-4535  
toll free: 1-877-352-7979

	NAME	DATE		
DRAWN	SD	Nov./12		
CHECKED				
ENG APPR.				
MFG APPR.				
COMMENTS:			SIZE	DWG. NO.
DO NOT SCALE DRAWING			A	ABPI PANEL-1
			SCALE: 1:1	REV. SHEET 1 OF 1

# ABPI PANEL PRODUCTS - Tank

FOR INDUSTRIAL, AGRICULTURAL, & COMMERCIAL APPLICATIONS

## ABPI - LAP JOINT - UTILIDOR SINGLE SKIN (TANK PANEL)

\*\*Board Stock w/ paper backing on request\*\*

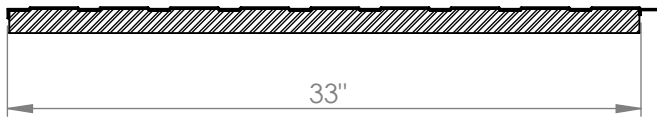
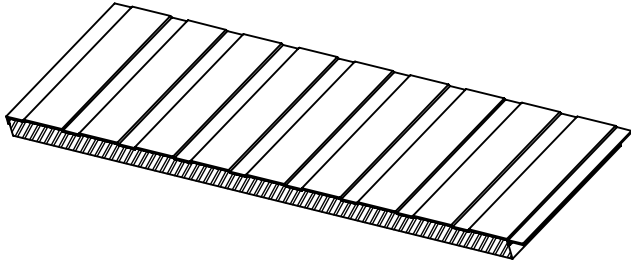

## ABPI - CORRUGATED LAP JOINT - SINGLE SKIN (TANK PANEL)

\*\*Board Stock w/ paper backing on request\*\*

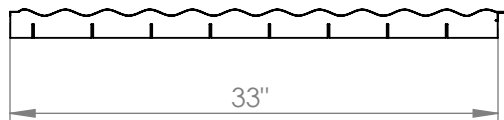
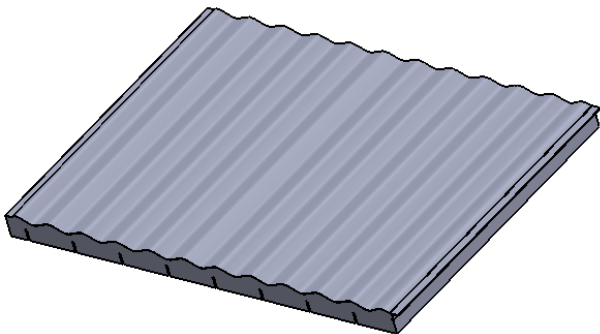

Tank panel foam with kerf cuts every 4" per 33" coverage.  
More cuts can be added to achieve a tighter bend radius.

## TECHNICAL INFORMATION

### Lap Joint Panel

Panel Thickness: 1 1/2", 2", 2 1/2", 3"  
\*\*4" & 6" available by request\*\*

### Corrugated Lap Panel

Panel Thickness: 1 1/2", 2", 2 1/2", 3"  
\*\*4" & 6" available by request\*\*

Panel Width: Lap Joint- 33" coverage  
Tank Panel- 33" coverage

Panel Length: Minimum: 4'-0"  
Maximum: 40'-0"  
other lengths available on request\*\*

Skin Thickness: Standard 26 ga.  
other gauges available by request\*\*

Skin Materials: Aluminum Stucco Embossed  
Clear (0.020 & 0.024)  
Galvanized (G90)  
Galvalume  
Painted  
Stainless Steel by request\*\*

Insulation: Polyurethane

Density: 2.5 lbs./cu.ft. minimum

R-Value: R 7.14 / inch

Operating Temperature: up to 100° C (212°F)

High Temp Foam Option: up to 150° C (300°F)

Please contact ABPI's Technical Department for more info.

## WEIGHT CHART: lbs/sq.ft.

Single Skin Skin Material	Panel Thickness						
	Ga.	1.5"	2"	2.5"	3"	4"	6"
Aluminum	24	0.6	0.7	0.9	1.0	1.3	1.9
Galvanized	26	1.3	1.4	1.5	1.6	1.8	2.2
Galvalume	26	1.2	1.3	1.4	1.5	1.7	2.1
Painted	26	1.2	1.3	1.4	1.5	1.7	2.1
Stainless Steel	26	1.1	1.2	1.3	1.4	1.6	2.0

Please contact ABPI's Technical Department for more info.



A Better Panel Inc.  
Box 6165  
4006 - 60th Ave  
Innisfail, AB  
T4G 1S8  
www.abetterpanel.com  
ph: 403-227-4545  
fax: 403-227-4535  
toll free: 1-877-352-7979

	NAME	DATE
DRAWN	SD	Nov./12
REV.	SD	June 17/13
COMMENTS:		
DO NOT SCALE DRAWING		

SIZE	DWG. NO.	REV.
A	ABPI PANEL-2a	
SCALE: 1:1		SHEET 1 OF 1

# Panel Profiles

## Mesa Profile

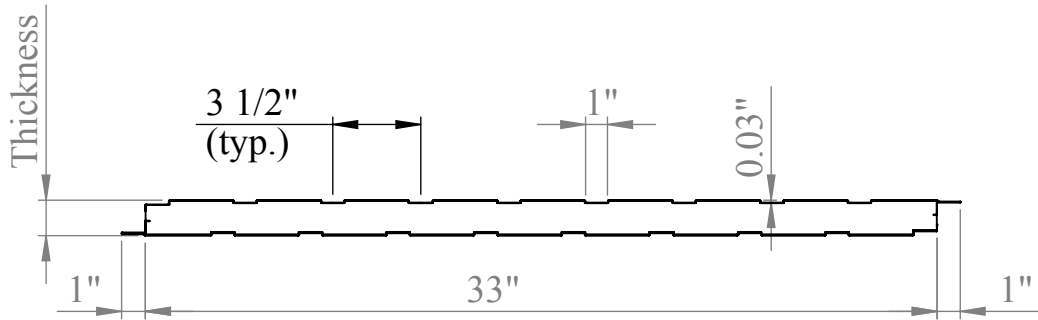

## Corrugated Profile

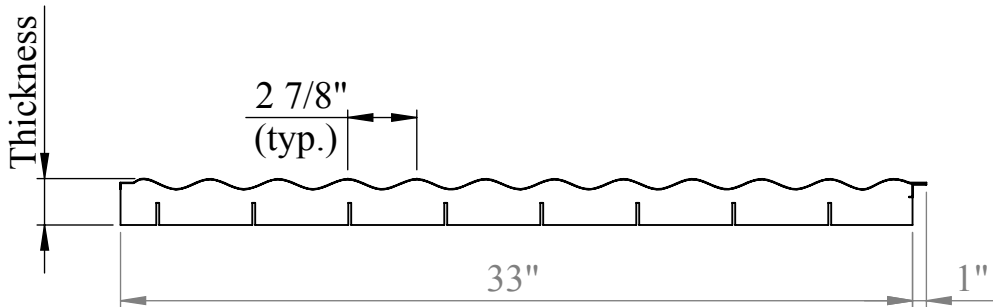

A Better Panel Inc.  
 Box 6165  
 4006 - 60th Ave  
 Innisfail, AB  
 T4G 1S8  
 www.abetterpanel.com  
 ph: 403-227-4545  
 fax: 403-227-4535  
 toll free: 1-877-352-7979

	NAME	DATE
DRAWN		
CHECKED		
ENG APPR.		
MFG APPR.		

COMMENTS:  
 DO NOT SCALE DRAWING

SIZE	DWG. NO.	REV.
<b>A</b>	Panel Profiles	
SCALE:1:1	SHEET 1 OF 1	